

RDM Services @ University Library LMU

Martin Spenger

10.02.2020

(NFDI Neuroscience: 3rd NFDI Community Workshop)

Research Data Management Plans

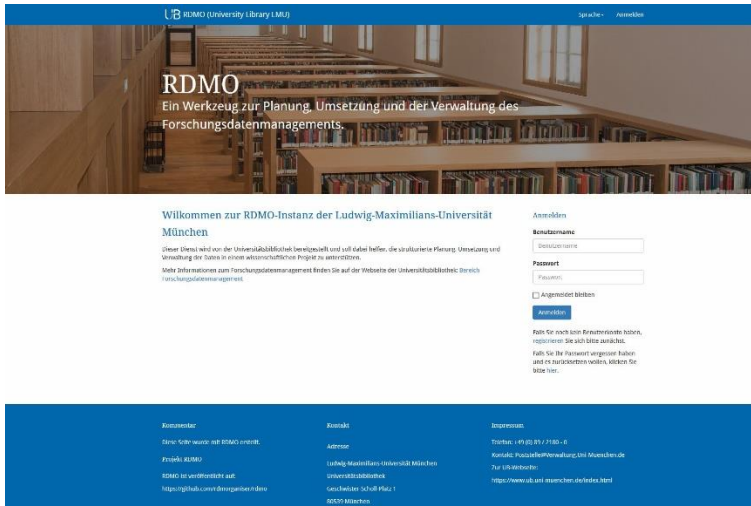

Tool: RDMO (RDM Organizer)

- Goals:
 - Optimizing data management
 - Supporting grant applications
- Pros:
 - Co-funded by DFG since 2015
 - Local installation possible
 - Adaptation to institutional environments (e.g. Corporate Design)
 - Interdisciplinary and compatible with various funding guidelines (e.g. DFG, BMBF, H2020)
 - Large and active community
 - Easy exchange of questionnaires
- Link to official RDMO website (incl. Demo):
 - <https://rdmorganiser.github.io/>

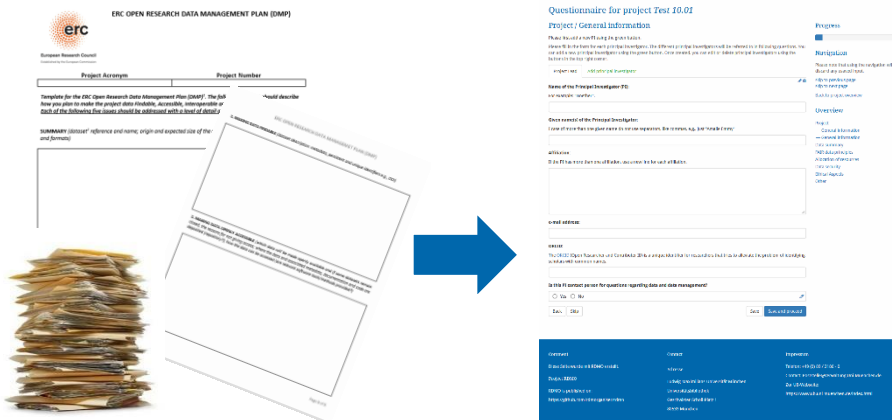

DOI Services / Metadata Know-how

- LMU University Library is a direct DataCite member since August 2019
- Services:
 - Assignment of DOIs
 - Assignment of Prefixes
 - DOI support for LMU members and affiliated projects
- DataCite Best Practice Guide:
<https://zenodo.org/record/3559800>
- DataCite Metadata Generator:
<https://github.com/UB-LMU/datacite-metadata-generator>



Welcome Universitätsbibliothek der Ludwig-Maximilians-Universität München to the Fabrica administration area.

DataCite Fabrica is the one place for you to create and find, connect and track every single DOI from your organization. Fabrica complements the REST, MDS, EZ, and OAI-PMH APIs. Fabrica includes all the functionalities needed to manage repositories, prefixes, DOIs and their metadata. Going forward, the service will provide stats and reports. Please sign in to use the service.



Repositories
Use Fabrica to manage your repositories.



Prefixes
Use Fabrica to manage your prefixes.



DOIs
Register and manage DOIs and their metadata through Fabrica.

Publication

- Institutional repository:
 - Open Data LMU
 - Implementing new software and interface (in 2020)
 - Fedora Repositories & Project Blacklight
- Additional publication services:
 - Open Access LMU / Open Journals LMU
 - <https://www.en.ub.uni-muenchen.de/writing/index.html>
- General support with RDM & FAIR Data (University Library LMU is active in various national & international interest groups)
- Experience in optimizing APIs, distributing data and long-term availability
- ORCID consortia member
- Co-founder of **Research Data Management in Munich** (rdmuc)
 - Informal exchange on everything „research data“
 - Current Participants: BSB, LMU, LRZ, MPCDF, TUM

